



DESCRIPTION

This compact, simple vacuum switch is suitable for many applications. It is designed for easy installation and quick access to the set point. It is available in factory set or adjustable ranges.

FEATURES

- Gold plated silver alloy contacts
- High current ratings
- Works well with extreme temperature
- Economical

APPLICATIONS

- Vacuum generators
- Industrial automation
- Engine load monitoring

Specifications

Electrical	Resistive	Inductive
	15 AMP - 6 VDC	1 AMP - 120 VAC
	8 AMP - 12 VDC	0.5 AMP - 240 VAC
	4 AMP - 24 VDC	
Switch Type	Blade Contact	
Protection	Terminals - IP00	
Temperature Range	-40°F to 248°F (-40°C to 120°C)	
Diaphragm Material	Standard: Fluorosilicone elastomer	
Housing Material	Brass, Glass Reinforced Polyester (Optional Stainless Steel)	
Maximum Operating Pressure	30 inHg Vacuum	
Burst Pressure	150 PSI (10.3 BAR)	
Weight	0.14 lbs (0.06 kg)	

Pressure Range

Model	Adjustment Range	
	inHg	Millibar
1	1.1 - 3	37 - 101
2	4 - 8	135 - 270
3	9 - 17	305 - 575
4	18 - 22	610 - 745

Dimensions

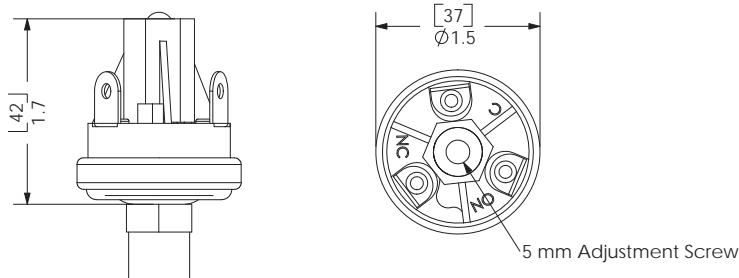

Wiring Code

CONTACT	FLYING LEADS	FLWF / FLWM WEATHERPACK	FLDR / FLDP DEUTSCH RECEPTACLE / PLUG
COMMON	BLACK	PIN A	PIN A / PIN 1
NORMALLY CLOSED	BLACK	PIN C	PIN C / PIN 2
NORMALLY OPEN	BLACK	PIN B	PIN B / PIN 2

Ordering Information

Field Adjustable

SPVL - ¹2 - ²2M - ³A - ⁴SP - ⁵2

1 - Pressure Selection:

Field Adjustable - Select Model Code

Insert set point value XXX followed by: R, F, MR, or MF

Model	Adjustment Range	
	inHg	Millibar
1	1.1 - 3	37 - 101
2	4 - 8	135 - 270
3	9 - 17	305 - 575
4	18 - 22	610 - 745

OR

Set point	Direction	Description
XXXX	R	inHg Rising Pressure
	F	inHg Falling Pressure
	MR	Millibar Rising Pressure
	MF	MiliBar Falling Pressure

2 - Thread Options:

- 2M - 1/8 NPT male
- 4M - 1/4 NPT male
- 2G - 1/8 BSPP male, G1/8
- 4G - 1/4 BSPP male, G1/4

3 - Circuit:

- A - SPST (Normally Open)
- B - SPST (Normally Closed)

4 - Electrical Termination:

- FL - Flying Lead 18" long, 18 AWG
- FLWF - Flying Lead Weatherpack connector, female, 10" long leads
- FLWM - Flying Lead Weatherpack connector, male, 10" long leads
- FLDP - Flying Lead Deutsch connector, plug, 10" long leads
- FLDR - Flying Lead Deutsch connector, receptacle, 10" long leads
- SP - 1/4" Spade
- TS - Terminal Screws, #8-32

5 - Options:

- 2 - EPDM Diaphragm
- 3 - 316 Stainless Steel Housing
- 20 - Seal adjustment Screw
- 30 - Rubber Boot - Removable



Note: Please see page 42 for other available options